

NEW VERSIGARD® DESIGN "B" | NEW VERSIGARD MECHANICALLY ATTACHED ROOFING SYSTEM

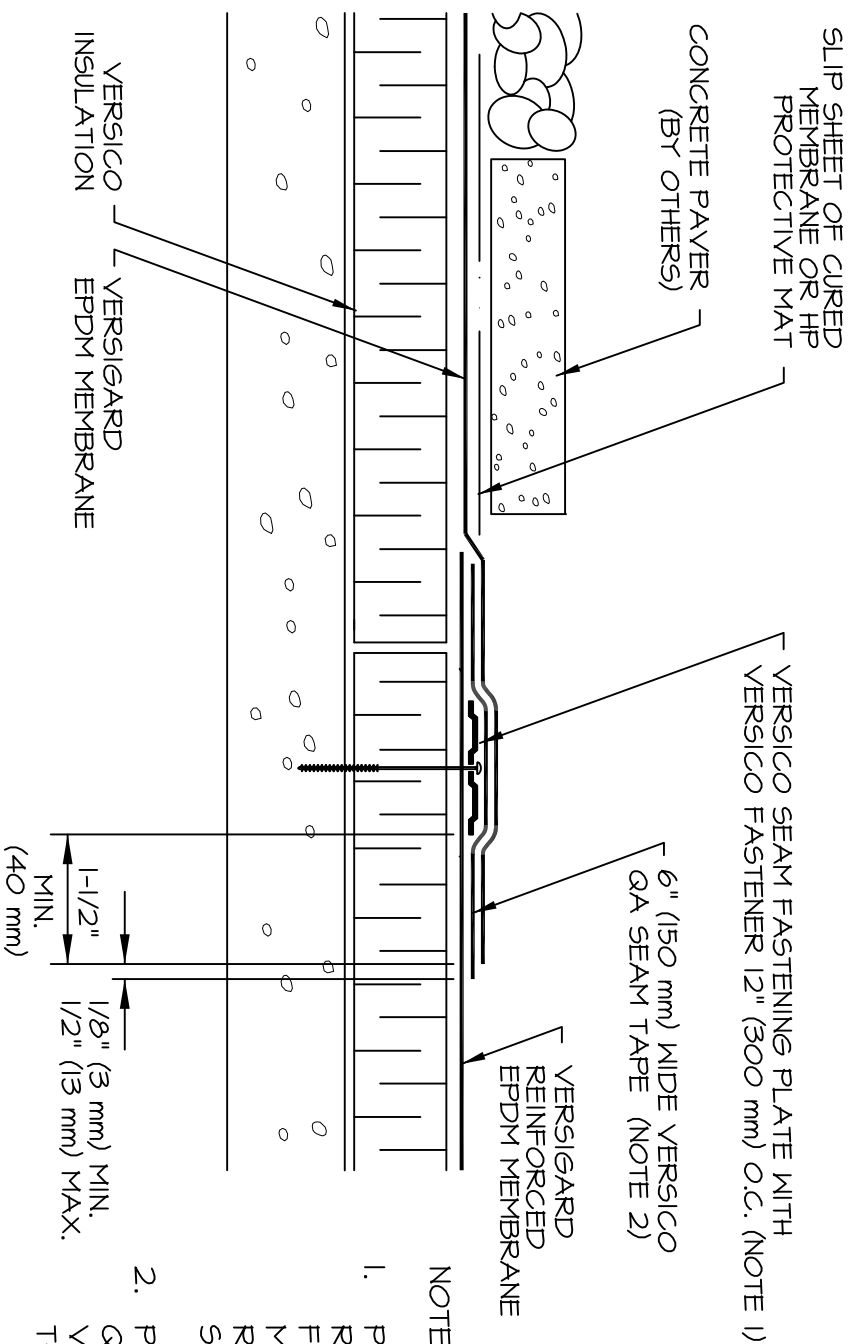

NOTES:

1. POLYMER SEAM PLATES ARE REQUIRED IN LIEU OF SEAM FASTENING PLATES FOR MECHANICALLY ATTACHED ROOFING SYSTEMS OVER STEEL DECKS.
2. PRIOR TO INSTALLATION OF QA SEAM TAPE, APPLY VERSICO EPDM PRIMER TO THE SPLICE AREA.

C-10.2

NEW VERSICO DESIGN "B" AND MECHANICALLY ATTACHED ROOFING SYSTEM