

EXISTING EPDM ROOFING SYSTEM | VERSICO ROOFING SYSTEM

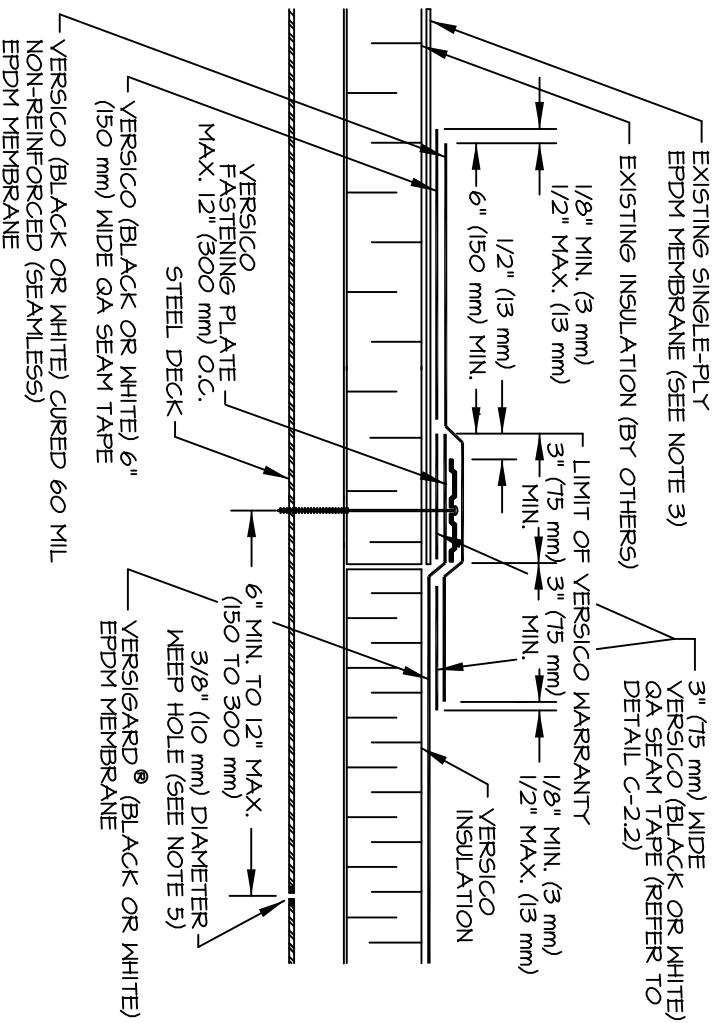

NOTES:

1. DETAIL APPLIES FOR STEEL DECKS WHEN **DECK SLOPE IS LEVEL OR IS TOWARD** VERSICO ROOFING SYSTEM.
2. PRIOR TO SPLICING, CLEAN EXISTING EPDM MEMBRANE BY SCRUBBING THE SPLICE AREA WITH WEATHERED MEMBRANE CLEANER AND ALLOW TO DRY.
3. CONTACT MANUFACTURER OF EXISTING EPDM MEMBRANE ROOFING SYSTEM TO VERIFY ACCEPTANCE OF TIE-IN AND TO NOT VOID EXISTING WARRANTY.
4. ON BALLASTED ROOFING SYSTEMS, USE CONCRETE PAVERS TO PREVENT BALLAST MIGRATION. FOR EXISTING BALLASTED SYSTEMS BY OTHERS, CONSULT RESPECTIVE MANUFACTURER FOR ACCEPTABLE GRAVEL CONTAINMENT TO PREVENT GRAVEL MIGRATION.
5. IF ROOF SLOPES TOWARD VERSICO SYSTEM, DRILL A 3/8" (10 mm) DIAMETER WEEP HOLE ON ALL BOTTOM FLUTES OF THE STEEL DECK ALONG THE PERIMETER OF THE TIE-IN 6" (150 mm) MINIMUM TO 12" (300 mm) MAXIMUM FROM THE SEAM FASTENING PLATE.
6. POLYMER SEAM PLATES ARE REQUIRED IN LIEU OF SEAM FASTENING PLATES FOR MECHANICALLY ATTACHED ROOFING SYSTEMS OVER STEEL DECKS.

C-13.5

EPDM TIE-IN - STEEL DECKS